

CHM

(Hermetic protection)

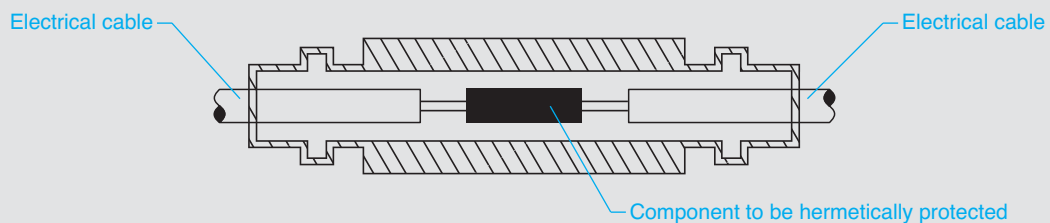
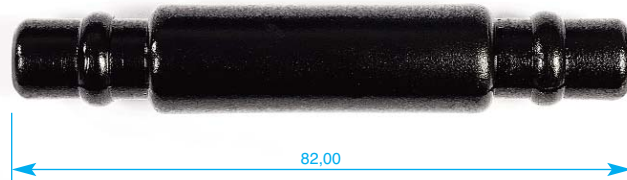
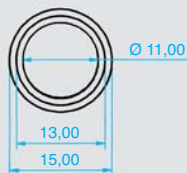
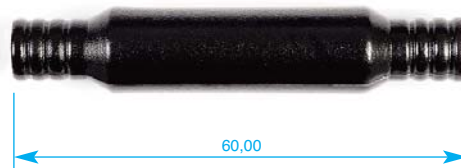
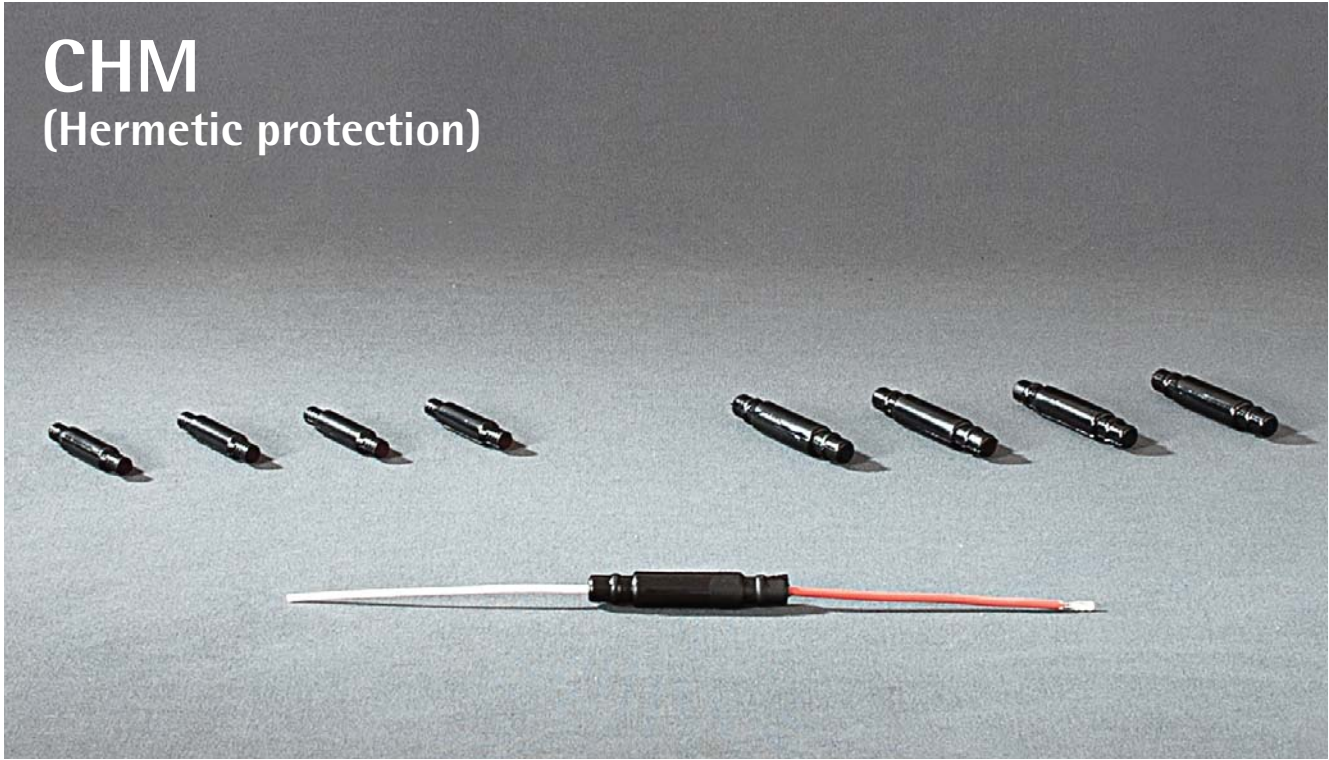

**HERMETIC HOT MELT
COVERINGS**

"SERIES CHM"

General features

The Hot Melt moulded coverings of the Series CHM are used to hermetically insulate and protect electrical and electronic components that must not come into contact with other components, metal parts or the external atmosphere. The CHM covering is made by moulding polyamide glue called Macromelt® at a low pressure, directly onto the component to be protected. By means of this technology, called Hot Melt, custom-made coverings can be produced.

Technical features

Properties of the Macromelt® adhesive

• Colour	Amber/Black	
• Chemical base	Polyamide	

Thermal properties

• Operating temperature	-40 °C ÷ +130 °C	
• Glass transition temperature	-35 °C	
• Cold flexibility	-40 °C	
• Temperature stability	+155 °C	
• Softening point	+175 °C	
• Injection temperature/point	+200 °C ÷ +240 °C	
• Thermal expansion coefficient	5×10^{-4} 1/K	
• Flammability	V0	

Mechanical properties

• Density	0,98 g/cm ³	
• Shore-A hardness	92	
• Yield stress	5 N/mm ²	
• Breaking stress	5 N/mm ²	
• Length at breaking	700 %	

Electrical properties

• Dielectric constant	5 ÷ 7 1kHz	
• Volume resistivity	10^{13} Ω/cm	
• Dielectric strength	20 kV/mm	

Application properties

• Viscosity bei 210 °C	7000 mPa s	
• Viscosity bei 220 °C	5000 mPa s	
• Viscosity bei 230 °C	3500 mPa s	
• Injection temperature/point	+200 ÷ +240 °C	

Water absorption

• Water absorption Note: depends on the project	0,8 %	
--	-------	--

**COMPANY WITH QUALITY MANAGEMENT
SYSTEM CERTIFIED BY DNV
= ISO 9001:2008 =**

La RTE si riserva il diritto di apportare eventuali modifiche al presente catalogo senza preavviso. *RTE reserves the right to make any modification to this catalogue without prior notice.*
I dati contenuti in questo catalogo sono basati su test che riteniamo validi, ma che non costituiscono garanzia implicita od esplicita. Potranno variare in qualunque momento in funzione di nuove conoscenze od esigenze, senza preavviso da parte della ns. società.

The information given in this catalogue is based on tests we believe to be valid, but it does not constitute intended or explicit guarantee. The information may vary at any time in accordance with updated knowledge and needs, without prior notification from our company.

Consigliamo ai ns. clienti di valutare l' idoneità dei ns. prodotti secondo la loro applicazione specifica.
We recommend that our customers assess the suitability of our products in regard to their specific application.

In nessun caso ci riteneremo responsabili per qualsiasi eventuale danno, indiretto o conseguente alla vendita, rivendita, trasferimento, uso o uso improprio del prodotto.
In no case shall we be considered liable for any damages, whether indirect or in consequence of the sale, resale, transfer, use or incorrect use of the product.